

# BDSG-37-24 Brush DC Gearmotor



## FEATURES

- DC Brush Motor with Spur Gearbox
- Designed for High-Volume Applications
- Up to 83 oz-in of Rated Torque
- Up to 250 oz-in of Peak Torque
- Gear Ratios Ranging up to 1,000:1

## DESCRIPTION

The BDSG-37-24 Series is designed for high-volume OEM applications with low cost being the primary objective. These Brush DC Spur Gearmotors come in variety of power levels, sizes, and gear ratios, and will be sure to fit your application's requirements. These motors are fully reversible and are a cost-effective solution to manage motion control in many rotary applications including medical, semiconductor, pumps, robotics, CNC, or any other situation when a low-cost Brush DC Spur Gearmotor is needed.

## DIMENSIONS

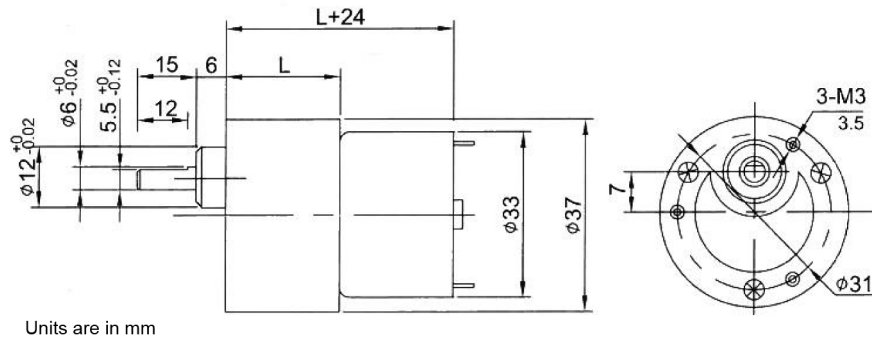

## BDSG-37-24-06V-2900-Rxx

Rated Voltage: 6V  
Rated Power: 0.56W

No-Load Current: 0.035A  
Rated Current: 0.17A

Stall Current: 0.46A  
Motor Stall Torque: 0.1 kg-cm

## SPECIFICATIONS

Gear Ratio (xx)	Length (L)	No Load Speed (RPM)	Rated Speed (RPM)	Rated Torque (oz-in)	Peak Torque (oz-in)	Rotation Direction
6	19	483	366	1	8	CCW
10	19	290	230	3	14	CCW
18	21.5	161	122	4	25	CW
30	21.5	96	73	7	42	CW
50	24	58	44	11	69	CCW
75	24	38	29	17	104	CCW
100	24	29	22	22	139	CCW
150	26.5	19	14	31	208	CW
200	26.5	14	11	40	250	CW
250	26.5	11	8	51	250	CW
300	26.5	9	7	61	250	CW
400	29	7	5.5	74	250	CCW
500	29	5.5	4.5	83	250	CCW
750	29	3.5	3	83	250	CCW
1000	29	3	3	83	250	CCW

L010784

## BDSG-37-24-12V-3000-Rxx

Rated Voltage: 12V  
Rated Power: 0.59W

No-Load Current: 0.03A  
Rated Current: 0.09A

Stall Current: 0.26A  
Motor Stall Torque: 0.1 kg-cm

Gear Ratio (xx)	Length (L)	No Load Speed (RPM)	Rated Speed (RPM)	Rated Torque (oz-in)	Peak Torque (oz-in)	Rotation Direction
6	19	500	383	1	8	CCW
10	19	300	230	3	14	CCW
18	21.5	167	127	4	25	CW
30	21.5	100	76	7	42	CW
50	24	60	46	11	69	CCW
75	24	40	30	17	104	CCW
100	24	30	23	22	139	CCW
150	26.5	20	15	31	208	CW
200	26.5	15	11	40	250	CW
250	26.5	12	9	51	250	CW
300	26.5	10	7.5	61	250	CW
400	29	7.5	6	74	250	CCW
500	29	6	4.5	83	250	CCW
750	29	4	3	83	250	CCW
1000	29	3	2.5	83	250	CCW

## BDSG-37-24-24V-3000-Rxx

Rated Voltage: 24V  
Rated Power: 0.59W

No-Load Current: 0.02A  
Rated Current: 0.08A

Stall Current: 0.14A  
Motor Stall Torque: 0.1 kg-cm

Gear Ratio (xx)	Length (L)	No Load Speed (RPM)	Rated Speed (RPM)	Rated Torque (oz-in)	Peak Torque (oz-in)	Rotation Direction
6	19	500	383	1	8	CCW
10	19	300	230	3	14	CCW
18	21.5	167	127	4	25	CW
30	21.5	100	76	7	42	CW
50	24	60	46	11	69	CCW
75	24	40	30	17	104	CCW
100	24	30	23	22	139	CCW
150	26.5	20	15	31	208	CW
200	26.5	15	11	40	250	CW
250	26.5	12	9	51	250	CW
300	26.5	10	7.5	61	250	CW
400	29	7.5	6	74	250	CCW
500	29	6	4.5	83	250	CCW
750	29	4	3	83	250	CCW
1000	29	3	2.5	83	250	CCW