

BDC-525 Brush DC Motor



FEATURES

- **DC Brush Motor**
- **4.0" (102mm) Diameter**
- **Up to 1025 oz-in of Torque**
- **Custom Versions Available**
- **160VDC**



DESCRIPTION

Anaheim Automation's DC motors provide a cost effective solution for your application. The BDC-525 series can be used in many applications such as robotics and medical applications. The BDC-525 series has strong permanent magnets to provide up to 1025 oz-in of torque. At rated voltage this motor will run up to 4100RPM.

SPECIFICATIONS

Model	BDC-525-102-229-160V-4100	BDC-525-102-229-160V-2200	BDC-525-102-152-160V-2500
Length "L" (in)	9	9	6
Rated Voltage (V)	160	160	160
Rated Power (W)	1365	833	416
Rated Torque (oz-in)	470	650	250
Rated Speed (RPM)	3930	1734	2251
Rated Current (A)	10.2	6.3	3.5
No Load Speed (RPM)	4100	2200	2500
No Load Current (A)	1	0.5	0.63
Maximum Torque (oz-in)	900	1025	475
Maximum Current (A)	20.6	10.7	6.6
Resistance Line-Line (Ω)	0.70	2.3	4.1
Inductance Line-Line (mH)	4.6	19.6	20.6
Electrical Time Constant (ms)	6.49	8.47	4.97
Mechanical Time Constant (ms)	17.1	11.9	14.9
Motor Velocity Constant (oz-in/Krpm)	38.1	83	64
Torque Constant Kt (oz-in/A)	51.5	112	87

L011265

BDC-525-102-229-160V-4100

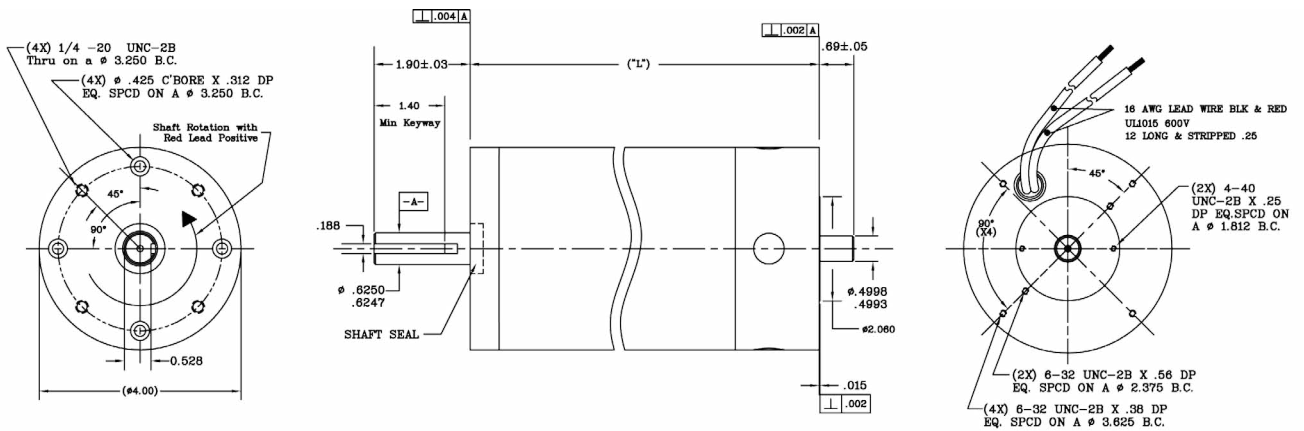
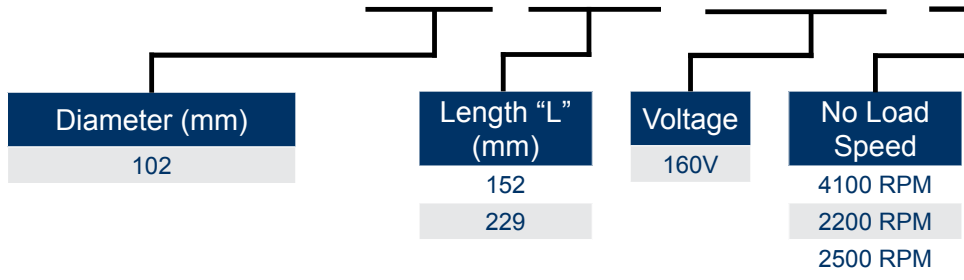

Dimensions are in inches