

- **DC Brush Planetary Gearmotor**
- **Operates with 12V and 24V DC Input**
- **Designed for High Volume Applications**
- **Continuous Torque up to 166.65 oz-in**
- **32 mm Motor Body Diameter**
- **Custom Versions are Available**



The BDPG 32 Series was designed for high volume OEM applications with low cost being the primary objective. These reliable low cost Brush DC Planetary Gearmotors come in a variety of power levels and sizes that will be sure to fit your needs. The motors are fully reversible. The BDPG 32 Series are a cost-effective solution to manage motion control in many rotary applications including medical, semiconductor, pumps, robotics, hobby, and many other applications where a low cost Brush DC Planetary Gearmotor is needed.

Model #	Voltage (V)	Gear Ratio (X:1)	No Load Speed After Gearbox (RPM)	Efficiency (%)	Rated Speed (RPM)	Rated Torque (oz-in)	Peak Torque (oz-in)	Rated Current (mA)	No Load Current (mA)	Rated Output (W)	Weight (lbs)	Gearbox Length (mm)
BDPG-32-38-12V-6500-R5	12	5	1300	80%	995	4.17	25.00	≤530	≤150	4.22	0.38	20.6
BDPG-32-38-12V-6500-R19	12	19	342.1	70%	270	13.89	95.00	≤530	≤150	4.22	0.43	27.0
BDPG-32-38-12V-6500-R35	12	35	185.71	70%	150	26.39	175.01	≤530	≤150	4.22	0.43	27.0
BDPG-32-38-12V-6500-R71	12	71	91.55	60%	74	45.83	333.30	≤530	≤150	4.22	0.49	33.4
BDPG-32-38-12V-6500-R139	12	139	46.76	60%	38	90.29	416.62	≤530	≤150	4.22	0.49	33.4
BDPG-32-38-12V-6500-R264	12	264	24.62	50%	20	138.90	499.95	≤530	≤150	4.22	0.54	39.8
BDPG-32-38-12V-6500-R939	12	939	6.92	50%	6.3	166.65	499.95	≤530	≤85	4.22	0.54	39.8
BDPG-32-38--24V-6500-R5	24	5	1300	80%	990	4.17	25.70	≤250	≤85	3.97	0.38	20.6
BDPG-32-38-24V-6500-R19	24	19	342.1	70%	265	13.89	97.65	≤250	≤85	3.97	0.43	27.0
BDPG-32-38-24V-6500-R35	24	35	185.71	70%	150	25.00	179.88	≤250	≤85	3.97	0.43	27.0
BDPG-32-38-24V-6500-R71	24	71	91.55	60%	74	43.06	333.30	≤250	≤85	3.97	0.49	33.4
BDPG-32-38-24V-6500-R139	24	139	46.76	60%	38	84.73	416.62	≤250	≤85	3.97	0.49	33.4
BDPG-32-38-24V-6500-R264	24	264	499.95	50%	20	134.74	499.95	≤250	≤85	3.97	0.54	39.8
BDPG-32-38-24V-6500-R939	24	939	499.95	50%	6.3	166.68	499.95	≤250	≤85	3.97	0.54	39.8

L011321

Housing Material:	Metal	Radial Play of Shaft:	≤ 0.08 mm
Bearing at Output:	Sleeve Bearings	Radial Load (10mm from flange):	≤ 3 kgf
Humidity:	20%~85% RH	Shaft Axial Load:	≤ 2.5 kgf
Backlash at No Load:	≤ 2.5°	Shaft Press Fit Force, Max:	≤ 10 kgf
Operating Temperature:	-10°C~+60°C	Thrust Play of Shaft:	≤ 0.3 mm

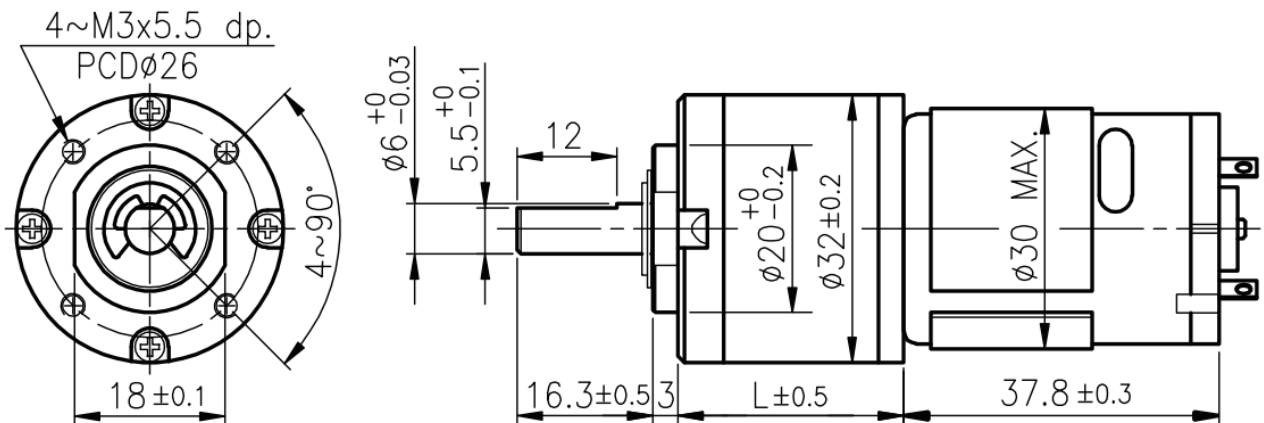

\* Dimensions are in mm

Gearbox Ratio	Gearbox Length (mm) (L)
1:5	20.6
1:14, 1:19, 1:27, 1:35	27.0
1:51, 1:71, 1:100, 1:139	33.4
1:189, 1:264, 1:516, 1:721, 1:939	39.8