

Step 1: Base Mounting

Place the base over the shaft and onto the mounting surface. Slide the centering tool onto the shaft so that it contacts and aligns the base. While applying light pressure to the centering tool, secure the base to the mounting surface using two or three screws depending on bolt circle preference. Remove centering tool.

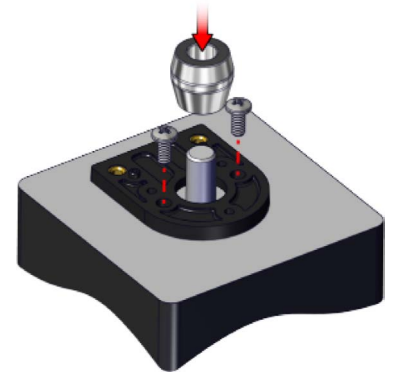

Step 2: Spacer Tool Installation

Place spacer tool onto base and fit around shaft as shown. Orient the hubdisk so that the disk is between the set screw and encoder base. Slip hubdisk assembly onto shaft and apply pressure so it bottoms out against the spacer tool.



Step 3: Codewheel Installation

While maintaining downward pressure on the hub tighten the set screw using the provided hex wrench.

Hub set screw:
2-3 in-lbs torque

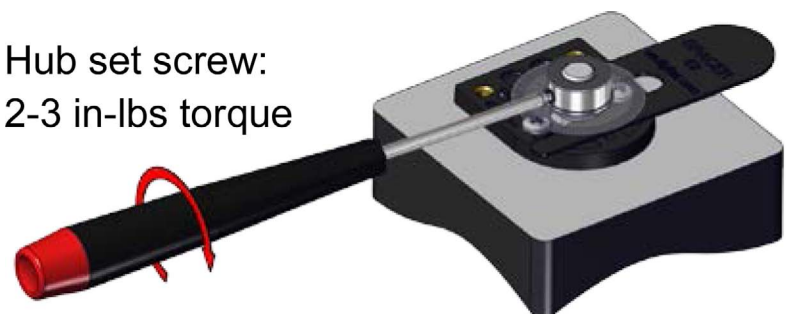

Step 4: Encoder Module Installation

Slip optical module into position so the two alignment pins slip into holes of module (thin side of module towards bottom).

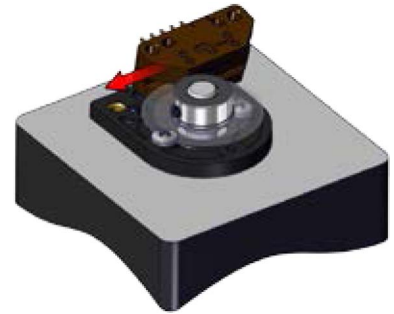

Step 5: Cover Installation

Place housing (cover) over assembly and secure with two 4-40 screws (supplied).

Cover screws:  2-4 in-lbs torque

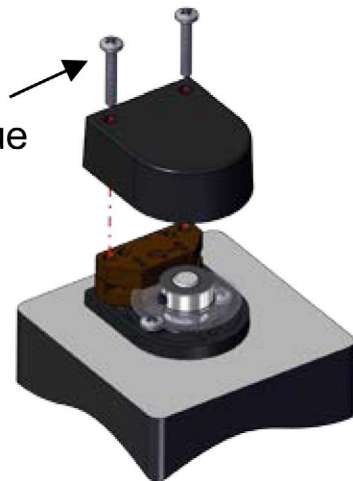

Parameter	Torque
Hub Set Screw to Shaft	2-3 in-lbs
Cover (4-40 Screw Through Cover Into Base)	2-4 in-lbs
Base to Mounting Surface	4-6 in-lbs
Base to Mounting Adapter Plate	4-6 in-lbs
Adapter Plate to Mounting Surface	4-6 in-lbs