

BDWG316 Series DC Brush Gearmotor

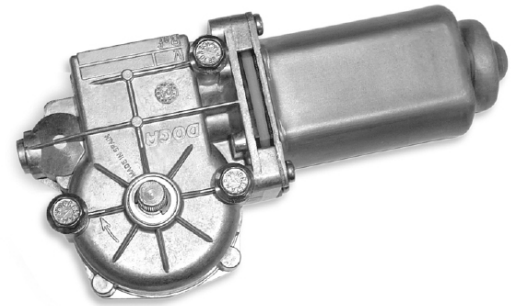

FEATURES

- DC Brush Worm Gearmotor
- Designed for High-Volume Applications
- Up to 283 oz-in of Rated Torque
- 48mm Motor Body Diameter
- 178mm Motor Body Length
- Mounting Screws Included



DESCRIPTION

The BDWG316 Series is designed for high-volume OEM applications with low cost being the primary objective. These reliable low cost Brush DC Worm Gearmotors come in a variety of power levels and sizes, and are fully reversible. The BDWG316 Series is a cost-effective solution to manage motion control in many rotary applications including medical, semiconductor, pumps, robotics, hobby, CNC, and many other applications where a low cost Brush DC Worm Gearmotor is needed.

SPECIFICATIONS

Model #	Rated Voltage (V)	Rated Current (A)	Max Current (A)	Rated Speed (RPM)	Rated Torque (oz-in)	Max Torque (oz-in)	IP Rating	Weight (lbs)	Torque Curves*
BDWG316NP-178-12-38-AL-C4-W3	12	3.4	12	38	283	1,416	IP40	2.41	11
BDWG316NP-178-24-38-AL-C4-W3	24	1.7	6	38	283	1,416	IP40	2.41	11
BDWG316NP-178-12-38-EL-C4-W3	12	3.4	12	38	283	1,416	IP40	2.41	11
BDWG316NP-178-24-38-EL-C4-W3	24	1.7	6	38	283	1,416	IP40	2.41	11
BDWG316NP-178-12-38-EL-C4-W8	12	3.4	12	38	283	1,416	IP40	2.41	11
BDWG316NP-178-24-38-EL-C4-W8	24	1.7	6	38	283	1,416	IP40	2.41	11
BDWG316NP-178-12-65-EL-C4-W3	12	6	22	65	212	1,416	IP40	2.41	12
BDWG316NP-178-24-65-EL-C4-W3	24	3	11	65	212	1,416	IP40	2.41	12

*See Torque Curves Section

*All units are in mm/in.

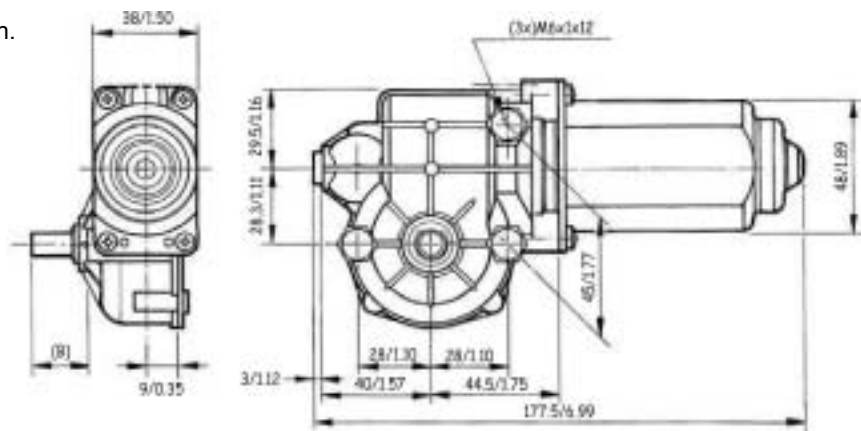

DIMENSIONS

L010802

BDWG316 **N** **P** - **178** - **12** - **38** - **A** - **L** - **C4** - **W3**

Gear Material	
P	Plastic
C	Resin Bonded Fabric
B	Bronze

Voltage	
12	
24	

RPM	
38	
65	

Wiring Options	
C4-W3	Amp Connector, 135mm Length, No Filter
C4-W8	Amp Connector, 135mm Length, Filter

Front Shaft Options	
A	
E	

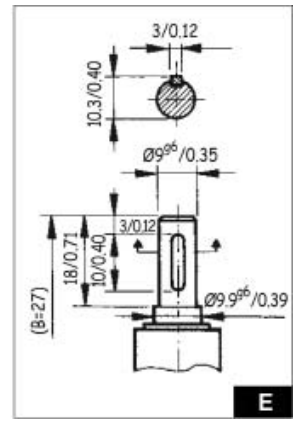
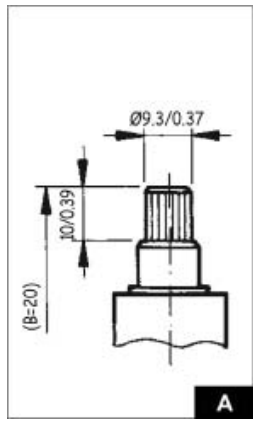

Mating Connector:
 Plug AMP 180907-0
 (2x) Female Terminal
 6.35

