

# BDBWG-80-176 Series - Permanent Magnet DC Motors with Worm Gearboxes



## FEATURES

- DC Brush Worm Gearmotor
- Design for High-Volume Applications
- Up to 1504 oz-in of Torque
- Custom versions are Available
- CE Certified and RoHS Compliant
- Mounting Screws Included



## DESCRIPTION

The BDBWG-80-176 Series is designed for high-volume OEM applications with low cost being the primary objective. These reliable low-cost Brush DC Worm Gearmotors come in a variety of power levels and sizes, and are fully reversible. The BDWG-80-176 Series is a cost-effective solution for many rotary applications including medical, semiconductor, pumps, robotics, hobby, CNC, and more. These low-cost Brush DC Worm Gearmotors are sure to fit your application requirements. These gearmotors measure 76.2 mm in diameter.

## SPECIFICATIONS

Model #	Rated Speed (RPM)	Torque (oz-in)	Gear Ratio	Overhung Load	Rated Current (A)	Weight (lbs)	Body Length (in)
BDBWG-80-176-1800-R5.2	360	224	5.2	270	1.28	14.5	6.95
BDBWG-80-176-1800-R10.3	180	432	10.3	300	1.28	14.5	6.95
BDBWG-80-176-1800-R13	135	560	13.0	300	1.28	14.5	6.95
BDBWG-80-176-1800-R20.5	90	784	20.5	300	1.28	14.5	6.95
BDBWG-80-176-1800-R30	60	960	30.0	300	1.28	14.5	6.95
BDBWG-80-176-1800-R45	40	1,312	45.0	300	1.28	14.5	6.95
BDBWG-80-176-1800-R60	30	1,504	60.0	300	1.28	14.5	6.95

\*Maximum overhung load on center of output shaft \*\*Output torque is gear limited

Gearing:	Hardened Steel Worm, Cast Bronze Gear
Housing:	Precision Machined Die Cast Aluminum
Lubrication:	Lifetime Oil Bath, Sealed and O-Ringed
Bearings:	Ball
Shafts:	Hardened Steel
Finish:	Gloss Black Powder Coat

## DIMENSIONS

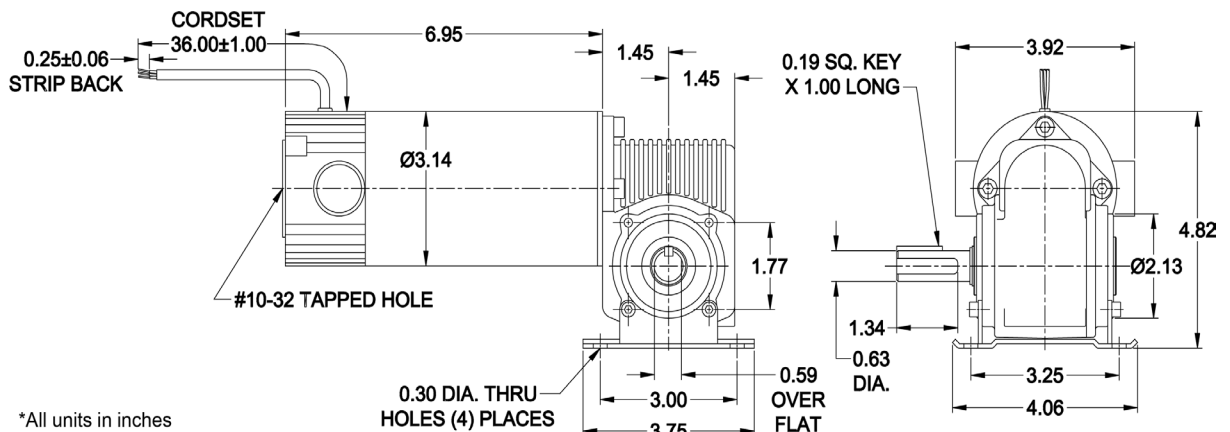

L010946