

BDPG-42 Series



FEATURES

- **DC Brush Planetary Gearmotor**
- **Operates with 12V and 24V DC Input**
- **Designed for High Volume Applications**
- **Up to 416.62 oz-in of Continuous Torque**
- **42 mm Motor Body Diameter**
- **Custom Versions are Available**



DESCRIPTION

The BDPG 42 Series was designed for high volume OEM applications with low cost being the primary objective. These reliable low cost Brush DC Planetary Gearmotors come in a variety of power levels and sizes that will be sure to fit your needs. The motors are fully reversible. The BDPG 42 Series is a cost-effective solution to manage motion control in many rotary applications including medical, semiconductor, pumps, robotics, hobby, CNC, and many other applications where a low cost Brush DC Planetary Gearmotor is needed.

SPECIFICATIONS

Model #	Voltage (V)	Gear Ratio (X:1)	No Load Speed After Gearbox (RPM)	Efficiency (%)	Rated Speed (RPM)	Rated Torque (oz-in)	Peak Torque (oz-in)	Rated Current (mA)	No Load Current (mA)	Rated Output (W)	Weight (lbs)	Gearbox Length (L) (mm)
BDPG-42-66-12V-7000-R4	12	4	1750	80%	1400	30.55	124.99	≤5500	≤900	41.3	1.1	32.5
BDPG-42-66-12V-7000-R24	12	24	291.67	70%	248	111.1	333.30	≤5500	≤900	41.3	1.22	39.2
BDPG-42-66-12V-7000-R61	12	61	114.75	70%	98	249.97	749.92	≤5500	≤900	41.3	1.31	45.9
BDPG-42-66-12V-7000-R144	12	144	48.61	60%	45	277.75	833.24	≤5500	≤900	41.3	1.31	45.9
BDPG-42-66-12V-7000-R294	12	294	23.81	50%	24	347.18	1041.55	≤5500	≤900	41.3	1.37	52.6
BDPG-42-66-12V-7000-R624	12	624	11.22	50%	10.9	416.62	1249.86	≤5500	≤900	41.3	1.37	52.6
BDPG-42-66-12V-7000-R1062	12	1062	6.59	40%	6.5	416.62	1249.86	≤5500	≤900	41.3	1.52	59.6
BDPG-42-66-12V-7000-R2500	12	2500	2.8	40%	2.7	416.62	1249.86	≤5500	≤900	41.3	1.52	59.6
BDPG-42-66-12V-7000-R3600	12	3600	1.94	40%	1.9	416.62	1249.86	≤5500	≤900	41.3	1.52	59.6
BDPG-42-66-24V-7000-R4	24	4	1750	80%	1445	25.0	124.99	≤2100	≤500	34.7	1.1	32.5
BDPG-42-66-24V-7000-R24	24	24	291.67	70%	246	11.10	333.30	≤2100	≤500	34.7	1.22	39.2
BDPG-42-66-24V-7000-R61	24	61	114.75	70%	102	249.97	749.92	≤2100	≤500	34.7	1.31	45.9
BDPG-42-66-24V-7000-R144	24	144	48.61	60%	47	277.75	833.24	≤2100	≤500	34.7	1.31	45.9
BDPG-42-66-24V-7000-R294	24	294	23.81	50%	23.8	347.18	1041.55	≤2100	≤500	34.7	1.37	52.6
BDPG-42-66-24V-7000-R624	24	624	11.21	50%	10.9	416.62	1249.86	≤2100	≤500	34.7	1.37	52.6
BDPG-42-66-24V-7000-R1062	24	1062	6.59	40%	6.5	416.62	1249.86	≤2100	≤500	34.7	1.52	59.6
BDPG-42-66-24V-7000-R2500	24	2500	2.8	40%	2.7	416.62	1249.86	≤2100	≤500	34.7	1.52	59.6
BDPG-42-66-24V-7000-R3600	24	3600	1.94	40%	1.9	416.62	1249.86	≤2100	≤500	34.7	1.52	59.6

L011322

Housing Material:	Metal	Radial Play of Shaft:	≤ 0.08 mm
Bearing at Output:	Sleeve Bearings	Radial Load (10mm from flange):	≤ 5 kgf
Humidity:	20%~85% RH	Shaft Axial Load:	≤ 3 kgf
Backlash at No Load:	≤ 3°	Shaft Press Fit Force, Max:	≤ 15 kgf
Operating Temperature:	-10°C~+60°C	Thrust Play of Shaft:	≤ 0.3 mm

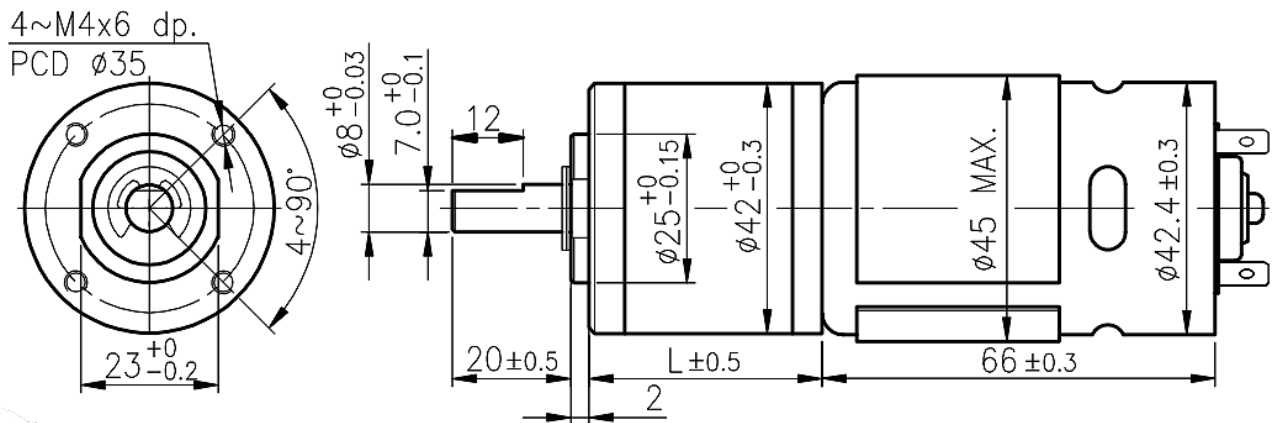

* Dimensions are in mm

Gearbox Ratio	Gearbox Length (mm) (L)
1:4	32.5
1:14, 1:17, 1:24	39.2
1:49, 1:61, 1:84, 1:104, 1:144	45.9
1:212, 1:294, 1:504, 1:624, 1:720, 1:864	52.6
1:1062, 1:1470, 1:2500, 1:3000, 1:3600	59.6