

TSM35-150 - Permanent Magnet Stepper Motor



FEATURES

- **Permanent Magnet Stepper Motor**
- **35mm Diameter**
- **15 Degree Step Angle**
- **Up to 4.65 oz-in of Bipolar Holding Torque**
- **Customization Available for:**
 - **Winding Current to Optimize Torque**
 - **Shaft Options**
 - **Cables or Connectors**
- **RoHS Compliant and CE Certified**



DESCRIPTION

These miniature Permanent Magnet DC Stepper Motors measure 35mm in diameter and provide up to 4.65 ounce-inches of bipolar holding torque. These motors come standard in a 15° step angle with a four-lead wire connection, and are offered in a 5V voltage rating. Customization is available for larger quantities.

SPECIFICATIONS

Item	# of Wires	# of Phases	Bipolar Holding Torque (oz-in)	Detent Torque (oz-in)	Bipolar Series RMS Voltage (V)	Current Per Phase (A)	Resistance Per Phase (ohms)	Rotor Inertia (oz-in-sec ²)	Weight (lbs)	Length (mm)
TSM35-150-22-5V-046A-LW4	4	2	4.65	1.74	5	0.46	11	0.0001058	0.18	22

Step Angle Accuracy	±8% (Full Step, No Load)	Insulation Resistance	100ΩMin. 500 VDC
Resistance Accuracy	±10%	Dielectric Strength	500VAC for One Minute
Inductance Accuracy	±20%	Shaft Radial Play	0.06Max (450 g-load)
Temperature Rise	80°C Max	Shaft Axial Play	+/- 0.5mm (450 g-load)
Ambient Temperature	-20°C to +50°C		

L010264

DIMENSIONS

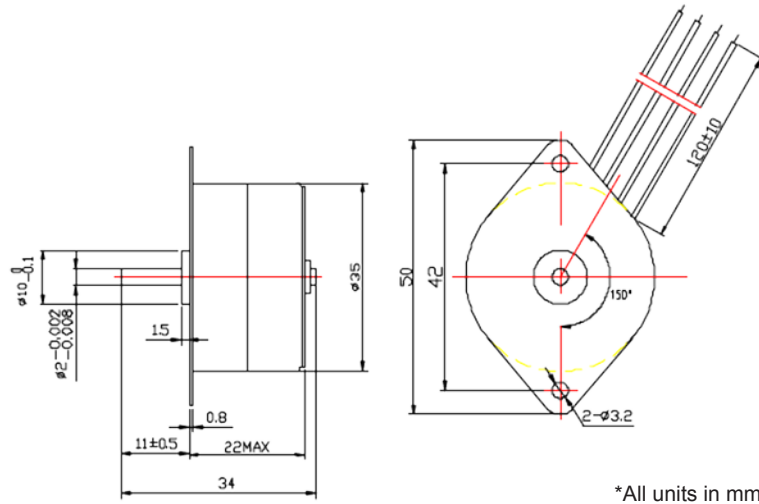

*All units in mm

WIRING DIAGRAM

